

S. BALDWIN ST.



WILLIAMSON STREET

- EXISTING - NO WORK
- DEMOLISH & REPLACE w/2 STORY ADDITION
- ALLEY - NEW 2-STORY INFILL CONSTRUCTION



PROJECT/BUILDING INFO
EXISTING BUILDING AREAS
TOTAL EXISTING BUILDING AREA = 23,541 SQFT
EXISTING FIRST FLOOR AREA = 22,407 SQFT
EXISTING SECOND FLOOR AREA = 1,034 SQFT
EXISTING RETAIL AREA = 15,078 SQFT
NEW CONSTRUCTION BUILDING AREAS
TOTAL NEW BUILDING AREA = 26,287 SQFT
NEW FIRST FLOOR AREA = 22,411 SQFT
NEW SECOND FLOOR AREA = 3,876 SQFT
NEW CONSTRUCTION RETAIL AREA = 15,161 SQFT

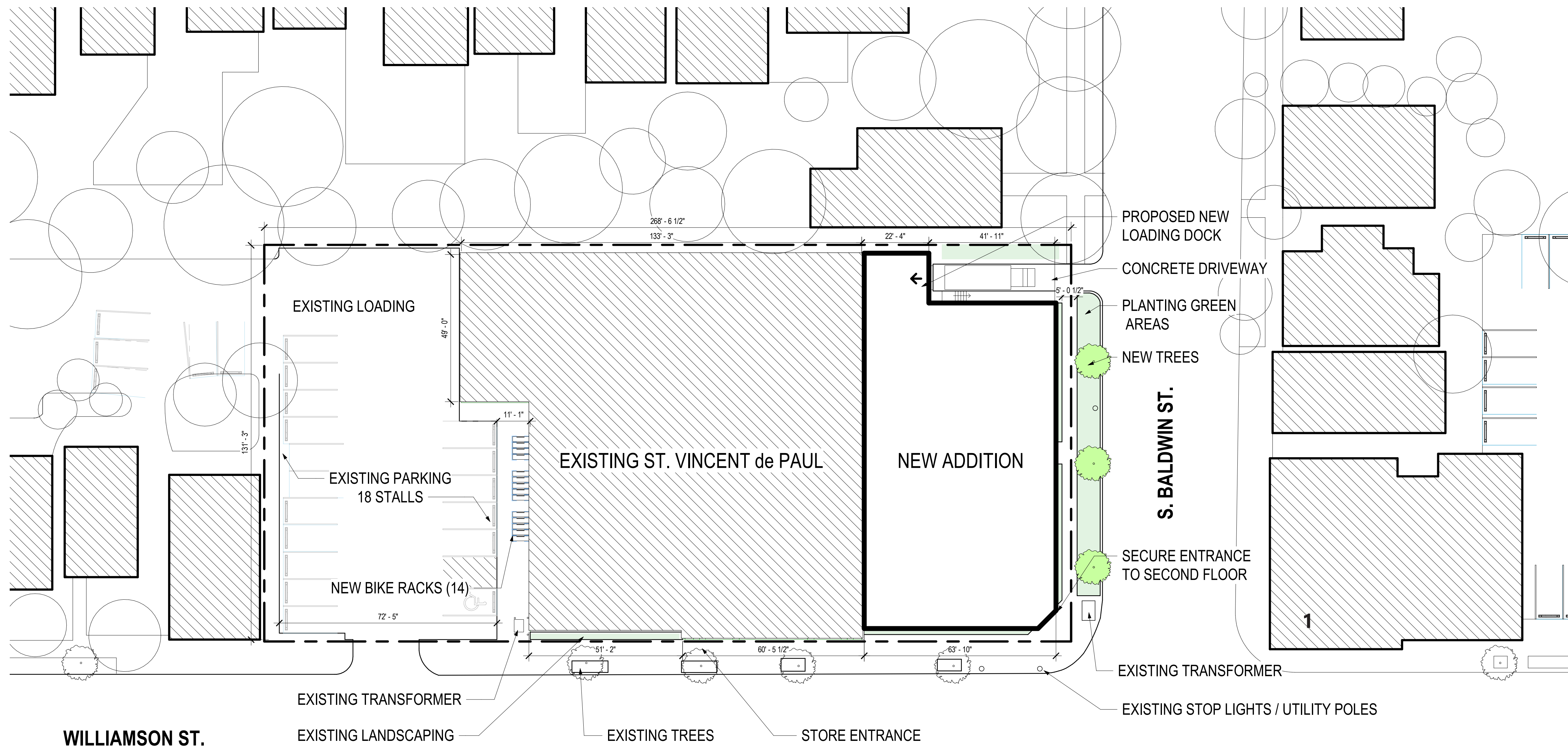

1 ARCH SITE PLAN (SEE ADDITIONAL DETAIL ON THE FIRST FLOOR PLAN)
1" = 20'-0"

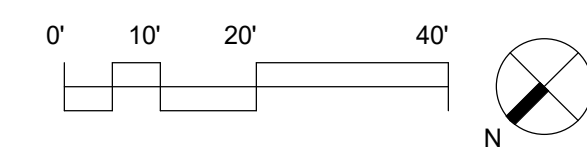



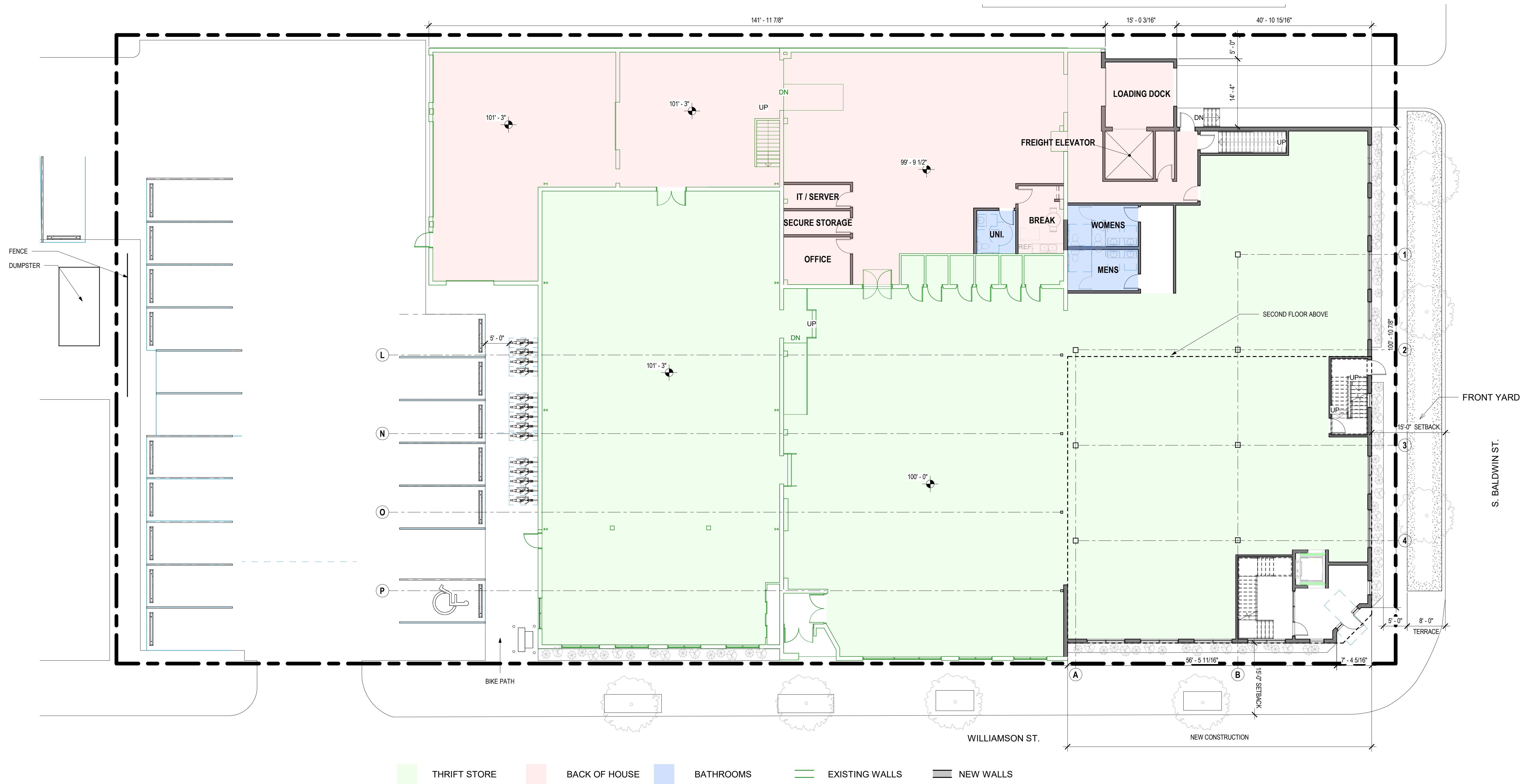

THRIFT STORE
 BACK OF HOUSE
 BATHROOMS
 EXISTING WALLS
 NEW WALLS

1 FIRST FLOOR PLAN
 3/32" = 1'-0"

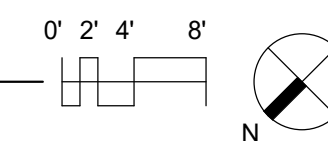

ST. VINCENT DE PAUL BALDWIN - WILLIAMSON



1 SECOND FLOOR PLAN
1/4" = 1'-0"

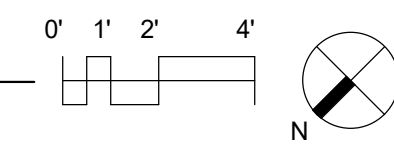



ST. VINCENT DE PAUL BALDWIN - WILLIAMSON

1309 Williamson St. Madison, WI 53703

WILLIAMSON ST RENDERING
06/05/22
21123

